

GENERAL LANDSCAPE SPECIFICATIONS:

General Instructions:

- Contractor is responsible for locating all underground services prior to any excavation, note that trees are to be offset a minimum of 2000mm from centerline of any underground service.
- Avoid planting trees under overhead wires, 3m offset recommended
- General layout of trees, planting beds, to be staked and confirmed by landscape architect prior to installation.
- Plant material to be approved at source by landscape architect, prior to shipment to the site.
- The landscape contractor, is advised that no tree planting is to occur during the months of December, January, February, March, and July.

Mulch:

All tree pits to be treated with shredded pine bark mulch, to a depth of 75mm minimum.

Plant Material:

All plant material shall conform to the standards of the Canadian Nursery Trades Association for size and species. All shrubs and tree material shall be container grown, potted, W/B or B/B, unless otherwise noted. Contractor shall make requests for root condition substitution in writing to the landscape architect prior to commencement of planting operations.

Plant Material Installation:

All trees, shrubs, and ground covers shall be planted as detailed and as shown on the planting plan. All beds to receive a cover of clean mulch to a depth of 75mm. For guying and staking trees, refer to the planting details.

The individual plant grouping total as illustrated on the planting plan supersedes the estimated quantity on the master plant list. Contractor must report any discrepancies to the landscape architect in writing before commencing any work. Contractor will assume full responsibility if landscape architect is not notified on discrepancies.

Ensure that top two rows of wire basket are removed from root ball after installation in planting pit, for all trees planted with wire basket.

General Maintenance:

Proper maintenance procedures are to be fully administered for all newly constructed landscape work in accordance with Landscape Ontario specifications. This shall apply during the construction and maintenance and warranty period. Contractor is responsible for maintenance of sod and plantings until final acceptance by landscape architect.

Rodent protection: the contractor shall be responsible for the protection of all trees and shrubs for winter protection and from rodent injury for the duration of the warranty period. Protective guards shall be employed around all deciduous trees.

General Requirements:

Use above specifications in conjunction with the general landscape specifications of the Ontario Landscape Contractors Association, The Nursery Sod Growers Association of Ontario and with the Guide Specifications for Nursery Stock of the Canadian Nursery Trades Association. Use only plant material true to name, size and grade as specified on planting plan: provide sufficient labels or markings to indicate clearly the variety, size and grade of each specimen or bundle.

Obtain approvals for substitutions as to variety, size or grade from the landscape architect. Use only nursery stock, grown under proper horticultural practices, viable, free from pest and disease and undamaged. Obtain all necessary permits before commencement of construction. Report in writing any discrepancies in the drawings, specifications and contract documents to the landscape architect before the end of the bidding process and commencement of construction. These specifications may be superseded by additional specifications set out in the tender documents. Contractor to review all documents.

Warranty:

The contractor will warrant all plant material with a one year (unless advised otherwise by owners representative) labour and material warranty, commencing final acceptance by the landscape architect.

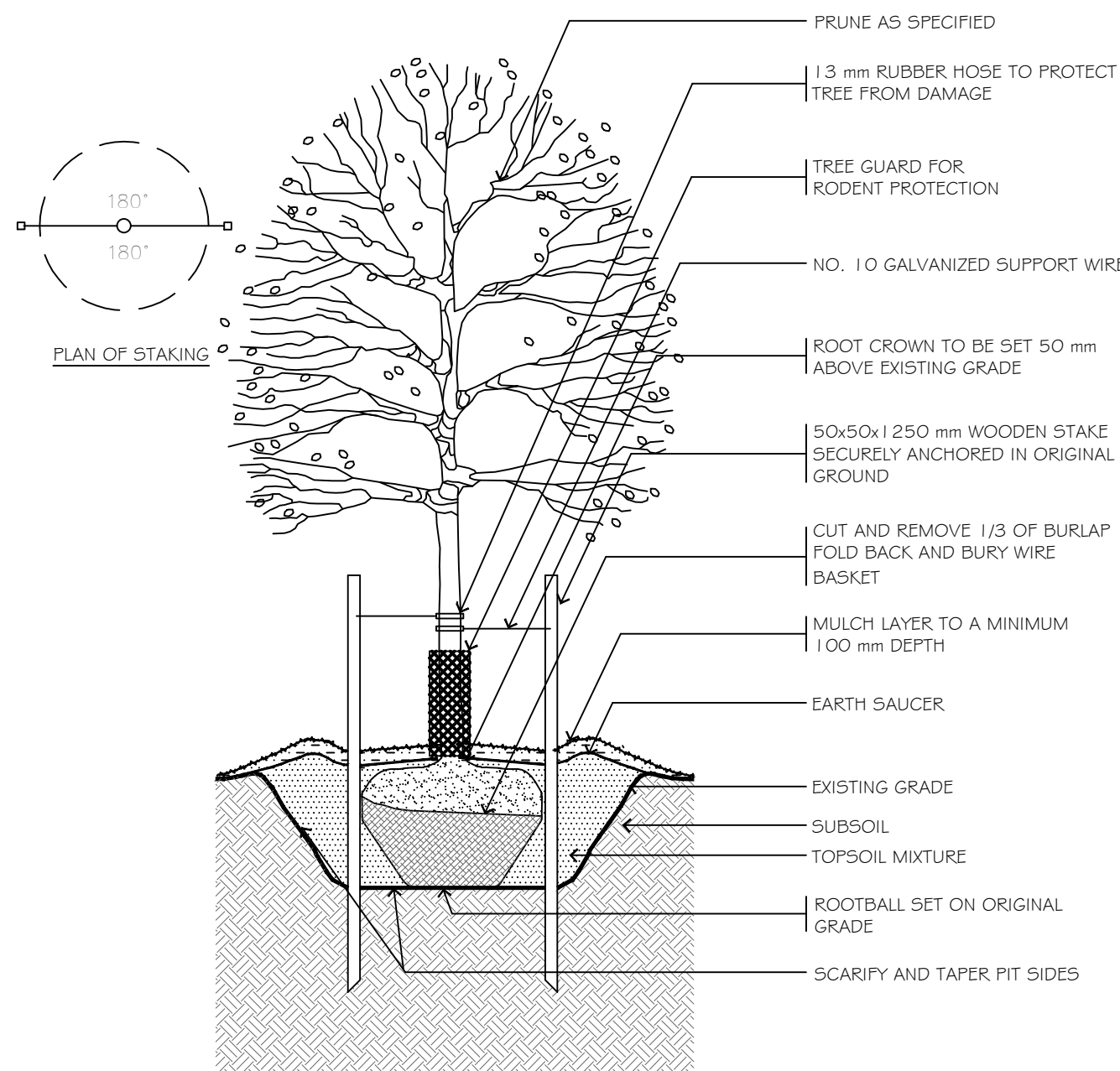
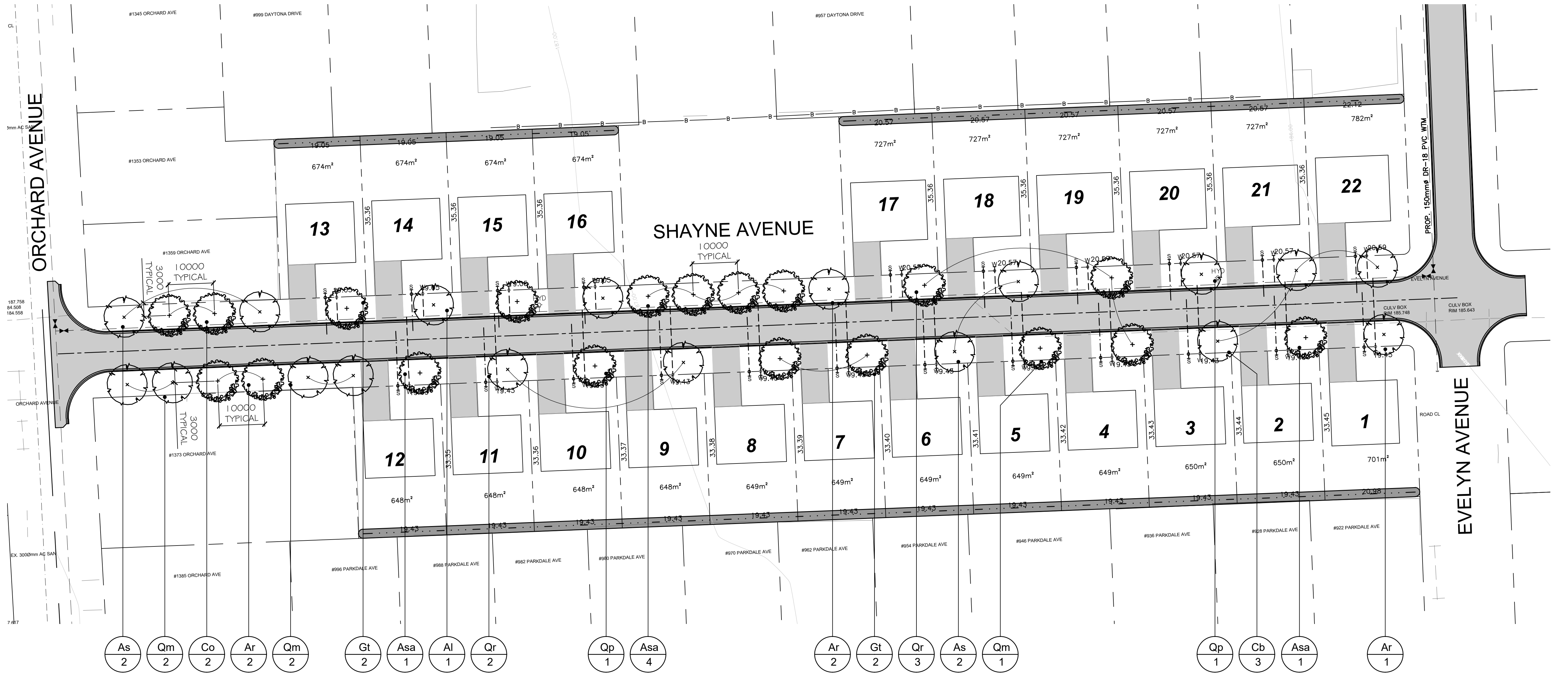

D1 TYPICAL DECIDUOUS TREE PLANTING DETAIL SCALE: NONE TREES OVER 45mm CALIPER

Shayne Avenue - PLANT LIST						
W.B. = Wire Basket, B&B = Balled and Burlapped, CT = Container Grown						
Code	BOTANICAL NAME	COMMON NAME	SIZE	#	ROOT CONDITIO	REMARKS
Deciduous Trees						
As	Acer saccharum	Sugar Maple	60mm cal.	4	W.B.	Full & equal form
Ar	Acer rubrum	Red Maple	60mm cal.	5	W.B.	Full & equal form
Asa	Acer saccharinum	Silber Maple	60mm cal.	6	W.B.	Full & equal form
Al	Amelanchier laevis	Serviceberry	60mm cal.	1	W.B.	Full & equal form
Co	Celtis occidentalis	Common Hackberry	60mm cal.	5	W.B.	Full & equal form
Gt	Gleditsia triacanthos x Inermis	Honeylocust	60mm cal.	4	W.B.	Full & equal form
Qm	Quercus macrocarpa	Burr Oak	60mm cal.	5	W.B.	Full & equal form
Qp	Quercus palustris	Pin Oak	60mm cal.	2	W.B.	Full & equal form
Qr	Quercus rubra	Red Oak	60mm cal.	5	W.B.	Full & equal form

NO.	DESCRIPTION	DATE
<p>JAMES McWILLIAM LANDSCAPE ARCHITECT</p> <p>jmwilliam@jmladesign.com</p>		
<p>SHAYNE AVENUE FORT ERIE</p>		
<p>LANDSCAPE PLAN</p>		
SCALE:		1:500
DATE:		JUNE 2022
DESIGN BY:		J.S.M.
DRAWN BY:		T.F.G.
SHEET:		L1